



**EXTREME COLD WEATHER
HEATED GLOVE**



 @sealskinz  /sealskinzfan  /user/SealSkinzOfficial  sealskinzinsta



SEALSKINZ LIMITED
36 Oldmedow Road, Hardwick Industrial Estate
King's Lynn, Norfolk, PE30 4PP
Tel: +44 (0)1553 817990 Email: info@sealskinz.com
Sealskinz is a registered trademark



MADE IN CHINA

100% WATERPROOF & BREATHABLE



**EXTREME COLD WEATHER
HEATED GLOVE**

INSTRUCTION MANUAL

1. CONNECTING THE BATTERIES

Plug the battery pack into the glove battery connector and place inside the glove pocket as shown in figure 1.

Once connected, the power switch on the glove will illuminate red, green, blue and then off indicating the heating element is ready to turn on.

Figure 1.
Connecting the batteries

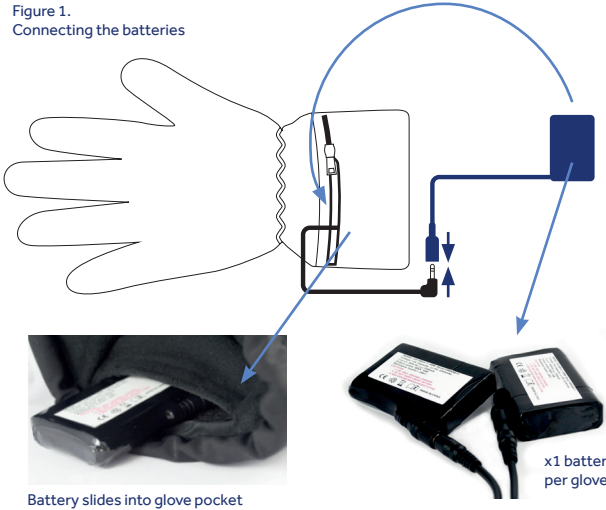

Battery slides into glove pocket

2. CHARGING THE BATTERIES

Remove the battery packs from the glove pockets and plug into the USB charging cable. The USB charging cable is a one piece unit featuring a boost converter, allowing it to be charged by a variety of USB devices. Plug the charging cable into a USB power supply. Whilst charging, the LED indicator will illuminate RED. When fully charged the LED will be illuminated GREEN.

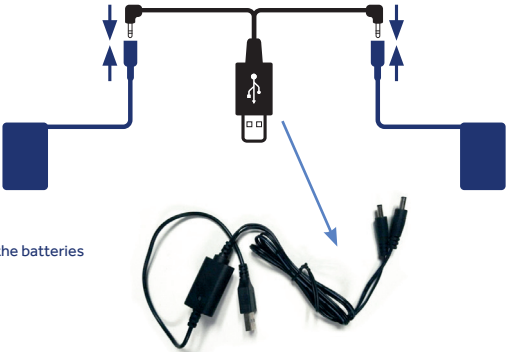

Figure 2.
Charging the batteries

3. OPERATION AND CONTROL

- 1. Press and hold the switch for 2-3 seconds to turn the heating unit on and activating power level 1, the LED will illuminate red – indicating 100% power usage.
- 2. Press and hold the switch for 2-3 seconds to activate power level 2, the LED will illuminate green – indicating 66% power usage.
- 3. Press and hold the switch for 2-3 seconds to activate power level 3, the LED will illuminate blue – indicating 33% power usage.
- 4. Press and hold the switch for 2-3 seconds to turn the heating unit off.



RED Indicates
100% power usage



GREEN Indicates
66% power usage



BLUE Indicates
33% power usage

4. HEATER CONTROL MENU

LED LIGHT COLOUR	BATTERY INPUT	HEATED SYSTEM TEMPERATURE	WORKING TIME
1st level Red	100%	60-65°C	2.0 – 2.5hrs
2nd level Green	66%	50-60°C	3.0 – 3.5hrs
3rd level Blue	33%	40-45°C	4.0 – 5.0hrs

5. PRODUCT CARE

The gloves can be wiped clean with mild soap and a wet cloth.

- ❌ DO NOT WASH
- ❌ DO NOT TUMBLE DRY
- ❌ DO NOT DRY CLEAN
- ❌ DO NOT USE BLEACH OR FABRIC SOFTENER

When not in use charge & disconnect the Battery Pack.
Store all parts in a cool, dry place.

6. TECHNICAL SPECIFICATION

Battery spec: 7.2V 200mAh Li-polymer rechargeable battery

Battery size and weight: 2 x (67.5 X 45.5 X 16.5mm) 70g/pcs

Battery working time: 2-5 hours

Battery charge time: First time charge 12 hours, then 6 hours

Battery operating temperature: +55~-20°C

ITEM	INPUT VOLTAGE	INPUT CURRENT	INPUT POWER
Battery	8.4V	1.2A	10.08W
USB Cable	5V	2A	10W

ITEM	OUTPUT VOLTAGE	OUTPUT CURRENT	OUTPUT POWER
Battery	8.4V (Max)	2.2A (Max)	18.48W (Max)
USB Cable	8.4V	1.2A	10.8W

7. WARNINGS AND SAFETY INFORMATION

As applies to any electronic product, the misuse of this product or failure to follow instructions may cause overheating, fire or personal injury. Always follow all the instructions and product labels.

- 1. Do not use the system if any of the cables are worn or damaged.
- 2. Do no place pins though the heater panel or garment containing a heater panel.
- 3. Never use this system with an infant, a child, an incapacitated person, anyone insensitive to heat or anyone who cannot clearly understand the instructions and/or operate the controls.
- 4. Do no use this system if you have a pacemaker.
- 5. Do not attempt to open the Battery Pack.
- 6. Do not operate the Battery Pack if it is wet.
- 7. Do not use the system if it is fully saturated wet OR while you are submerged in water.
- 8. Do not use the system to dry out the garment.