

EN

MAGICSHINE®

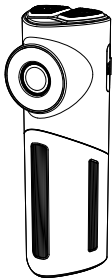

SEEMEE DV
USER MANUAL

⚠ WARNING



IN THE BOX



SEEMEE DV



Seat post mount



16GB
microSD card



Type-C
charging cable

OPERATION INSTRUCTIONS

ON/OFF: Press and hold the power button to turn the light on/off, the default output is the last mode when turned off.

ENABLE/DISABLE THE DV: When the light is on, the DV function is turned on by default. Press and hold the camera button to turn on/off the DV function.

VIDEO RECORDING: When the DV function is on, click the camera button to start/pause the video recording.

PHOTO TAKING: When the DV function is on, double click the camera button to take pictures.

DV INDICATOR:

1. When the DV is in video recording mode, the indicator light will circle clockwise with red light.
2. When the DV is in pause recording or standby mode, the indicator light will keep flashing red.
3. When the DV is in an abnormal state, the indicator light will keep flashing white.

AUTOMATIC INCIDENT CAPTURE: With a built-in accelerometer, the taillight continuously records and automatically saves videos (before 5s, during, and after 55s of the event) if it detects an incident, and you can access or download the footage through the APP (Album>Camera Browser>Event).

*The sensor's sensitivity can be adjusted via the APP (Setting>GST "G-sensor Shake Trigger") to prevent unexpected triggering.

CHANGE MODE: When the light is on, click the power button to cycle through LOW-HIGH-FLASH-ECO FLASH mode.

MEMORY FUNCTION: When the light is turned on again, it will turn to the last selected lighting mode automatically.

LOW POWER MODE: When the remaining battery power is lower than 10%, the lighting mode changes to ECO FLASH mode. The DV function is disabled during this period.

OUTPUT / RUNTIME

	BRIGHTNESS	DV ON	DV OFF
LOW	10LM	10h	35h
HIGH	30LM	8.5h	12h
FLASH	30-0LM	9h	70h
ECO FLASH	10-0LM	10h	110h

*All data are measured in accordance with ANSI/NEMA FL 1-2009. The test was conducted at a temperature of 25°C and a wind speed of 25 km/h. The runtime may vary depending on external temperature and ventilation conditions, and these deviations may affect the result of testing.

CHARGING / BATTERY INDICATOR

When the light is off, click the power button to display the remaining battery level for 3 seconds.

Charging: Flash red

Fully charged: Constant green
Standard charging time approx.
4.5 hrs (5V 1A)

BATTERY INDICATOR

21%-100%: Constant green

11%-20%: Constant red

1%-10%: Flash red

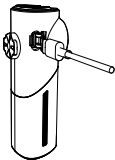

HOW TO INSTALL

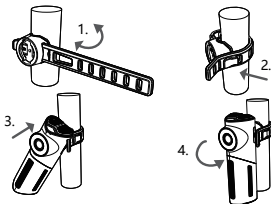

APP PAIRING



Scan and download the App, connect your phone to the WIFI prefixed with CARDV, enter the initial password 1234567890 and check DV videos and photos via your phone after the connection is completed.